

LENS BRASILIA

CHARAKTERISTIK:

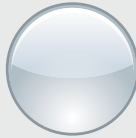

Medium



Polished



PC

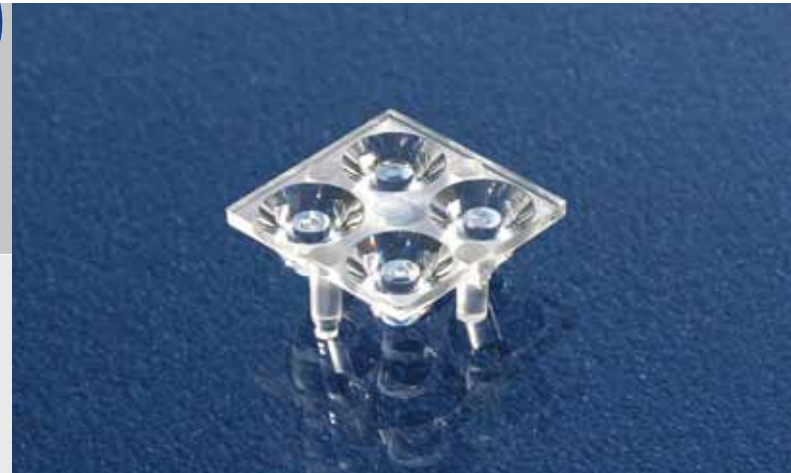

LENS BRASILIA

Artikel-Nr.:	L054-AP-428
Typ:	2 x 2 Reflector Lens
Größe:	19.95 x 19.95 x 8.5 mm
Charakteristik:	Medium
Oberfläche:	Polished
FWHM:	16°
Effizienz theoretisch:	78 %
Material:	PC

Alle Angaben / Maße sind Circa-Angaben und unverbindlich, technische Änderungen vorbehalten.
Unverbindliche Labormesswerte bezogen auf eine Referenz LED.

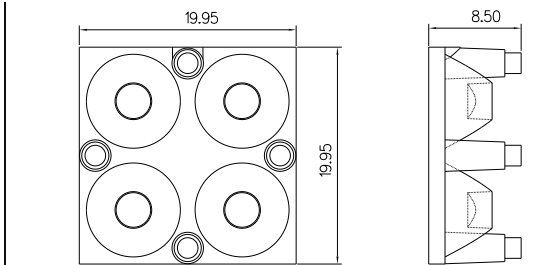

- » Vierfacharray mit Montagebeinchen zur einfachen Fixierung auf der Platine
- » Besonders geeignet für Hintergrundbeleuchtung
- » Plane transparente Lichtaustrittsfläche
- » Abstrahlcharakteristik Medium

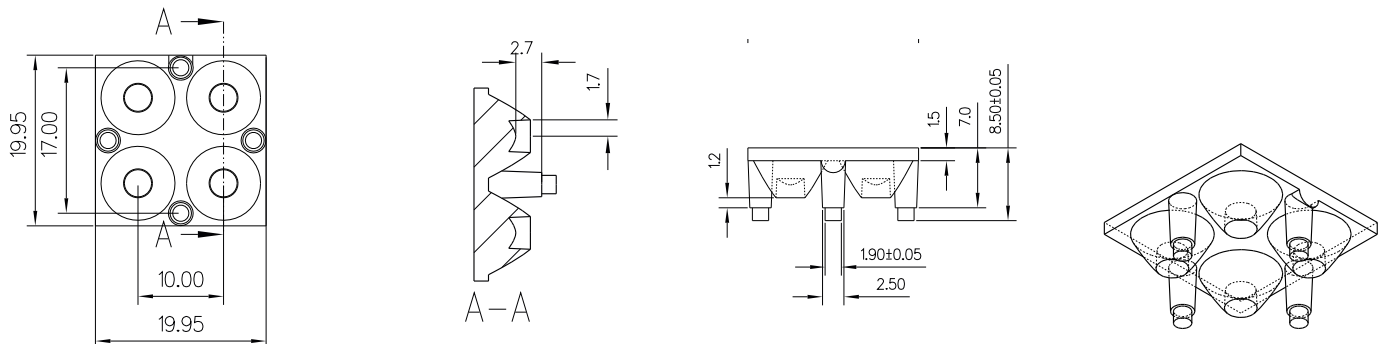

CREE XP-G2

Strahldaten

FWHM 16.0°

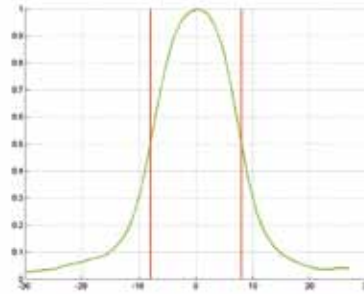

NICHIA 219

Strahldaten

FWHM 15.3°

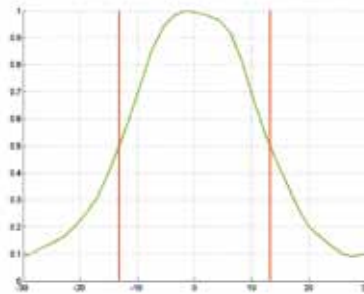

OSRAM

Opto Semiconductors

SSL80

Strahldaten

FWHM 16.6°

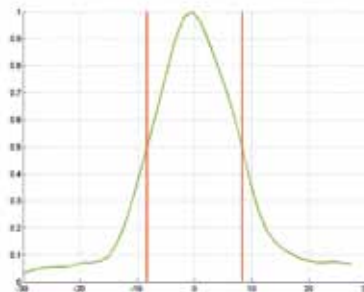

OSRAM

Opto Semiconductors

SSL150
Strahldaten

FWHM 15.3°

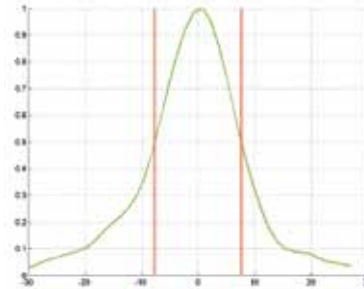
PHILIPS

Luxeon REBEL

Strahldaten

FWHM 18.5°

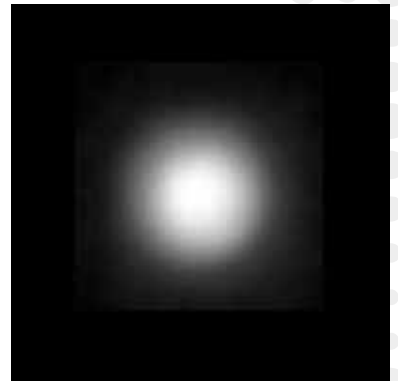
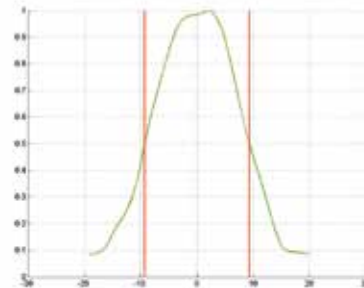
SAMSUNG
3535
Strahldaten

FWHM 23.9°

